

Retail Outlet Design

JONERY MANUFACTURER
DESIGN & SHAPFITTING
FOR THE RETAIL TRADE

Unit 14, Kent St. Mill
Kent Street
Blackburn
Lancashire BB1 1DE
Tel: 01254 677140
Email: ruth@retailoutletdesign.co.uk
Mob: 07718 003192

Woodwork Finish	see spec
Skivoleil Inset Colour	see spec
Paint	see spec
Shelving Colour	see spec
Shelving Tims	see spec
Goods Height	see spec
Wall Height	see spec
Retail Area	see sq. m

Client Name: Sealed Aikter
Contact Number: 07903 918856

Site Reference: Sid Eastway

Site Address:
146 TOTTINGTON RD
Bury
BL8 1RU

Date:
Drawn By:
skb

Drawing Number:
sk0001
Option
1

All plans and quotations remain the property of Retail Outlet Design, who retain the copyright. No plans may be copied or used to obtain quotations by other persons or companies, without the written permission from Retail Outlet Design. All dimensions are subject to full measure up on an empty

PROPOSED PLANS

- SMOKE ALARM AT BACK AND FRONT OF SHOP AREA
- FIRE EXTINGUISHER IN KITCHEN AND BEHIND COUNTER

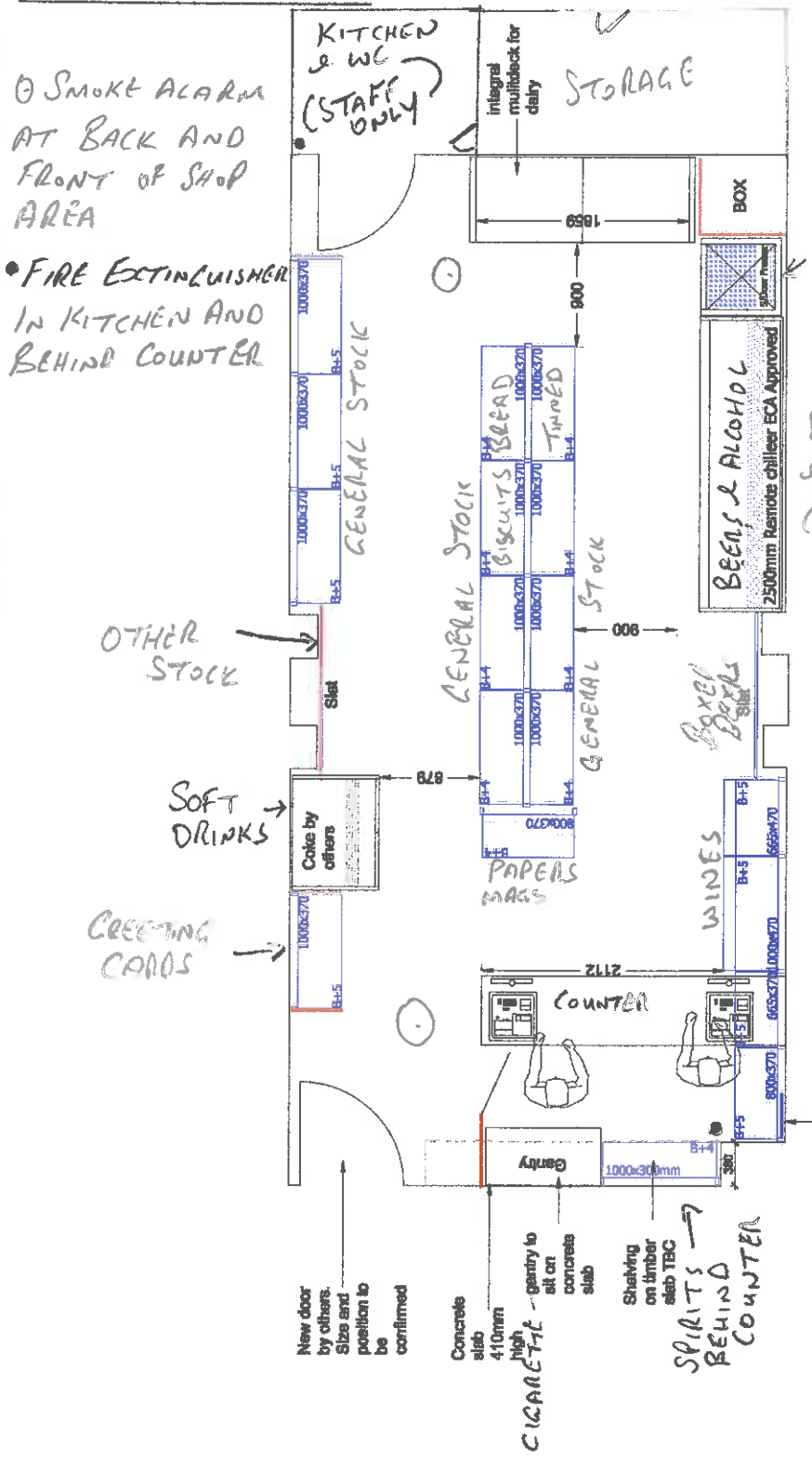

- 4 CCTV CAMERAS TO BE INSTALLED 2 IN BACK CORNERS OF SHOP & 2 ABOVE FRONT COUNTER AREA.
- BURGALAR ALARM TO BE INSTALLED TOO.

OTHER STOCK

SOFT DRINKS

CHEATING CANS

shelving over electricis.
Access required

Ceiling Height (structural) 2083mm
Exposed walls to be painted by others
Slit only where required

New door by others.
Size and position to be confirmed

Concrete slab 410mm high
garity to sit on concrete slab

Shelving on timber also TBC
SPRITS BEHIND COUNTER